

SESE Community Conversation: 30 September 2021

COVID Update – Fall 2021

- ASU continues in Learning Mode 1: classes taught in mode of instruction in the course catalog (modifications require Provost approval)
- Masks are required in class

The university continues to recommend strongly that people get vaccinated and ASU continues to provide COVID-19 vaccines free of charge to students, faculty and staff.

Current positive case count:

- 31 known positives among 21,522* faculty and staff, which is 0.14% confirmed positive. That compares with 27 in our last update.
- 195 known positives among our student body of 77,063 (excluding ASU Online), which is 0.25% confirmed positive. That compares with 200 in our last update.
 - 172 of the 195 are off campus in the metropolitan Phoenix area.
 - 14 are in isolation on the ASU Tempe campus, where 12,017 students live; 9 students are in isolation on the ASU Downtown Phoenix, ASU West or Polytechnic campuses. A total of 1,822 students live in university housing on the ASU Downtown Phoenix campus; 664 students live on the ASU West campus; and 888 students live on the ASU Polytechnic campus.

**Includes all full- and part-time employees from ASU, ASU Preparatory Academy and ASU Enterprise Partners.*

COVID Update (cont.)

- Cleaning supplies in each classroom and large conference rooms. Instructors (and conference room users) are encouraged to ask students or occupants to wipe down their seating areas before sitting down.
- Cleaning materials (disinfectant wipes, spray cleaner) & masks remain widely available. To restock classroom supplies, contact marc.biren@asu.edu.
- Individuals and research groups may purchase reusable cloth face coverings, Community of Care kits and travel kits from ASU Materials Management via Workday.
- ASU employees must take the 2021 Community of Care training: <https://rebrand.ly/Community-of-Care-2021>

Access to free vaccinations and COVID testing remain easy and convenient:

- General COVID testing information is available here: <https://cfo.asu.edu/covid-19-testing>
- Convenient Drop Off Testing Information is available here: <https://devilsdropoff.asu.edu/>
- Vaccine for students and employees: <https://asuportal.pointnclick.com/Mvc/Portal/Login>

COVID Update (cont.)

If you or someone you know tests positive for COVID, please follow the protocols on reporting and safety precautions (“COVID-19 Reporting Procedures”) noted on this webpage: <https://sese.asu.edu/school-earth-and-space-exploration-covid-19-information>

- Instructors, with respect to students, please email the student’s name and ASU ID number if you know them to the deanofstudents@asu.edu as soon as possible so they may provide support and care to the student. That information will be shared with ASU Health Services to assist in determining the next steps and for contact tracing. Please respect the privacy of this information.
- Faculty and staff with positive COVID-19 tests or other exposure concerns should contact Exposure Management at 480-727-6517. They are open seven days a week, 8am to 5pm. Website is <https://cfo.asu.edu/exposure-management>.

News and Other Updates

- SESE Strategic Plan for Equity, Diversity, & Inclusion
- Facilities and Infrastructure:
 - NSF funds a major new national facility (FORCE) at ASU
 - PSF renovation & ISTB4 space
 - SESE Virtual Classroom
 - Upgrade of ISTB4 exhibit gallery

SESE Strategic Plan for Equity, Diversity, & Inclusion

- Inclusive Community Committee has been established:

Patrick Young, co-chair

Christine O'Donnell, co-chair

Debbie Garcia (ex officio)

Everett Shock

Karen Knierman

Sanchayeeta Borthakur

Heather Throop

Aaron Boyd

Kimberley Baptista

Melanie Narish

Alan Jackson

Jackie Monkiewicz

Luiza Teophilo Aparecido

Aliya Hoff

Mara Karageozian

Alexa Drew

Claire Richardson

Miles English

Searra Foote

FORCE: Facility for Open Research in a Compressive Environment

\$13.7M awarded by NSF for a national facility that will provide access to a combination of new high-pressure capabilities that do not currently exist in the U.S.

ASU PI's: Kurt Leinenweber, Alexandra Navrotsky, Sang-Heon Shim, Thomas G. Sharp, David J. Smith.

ASU senior personnel: Christy Till, Sefaatin Tongay, Richard J. Hervig

Outside Senior Personnel: Carl Agee, Pamela Burnley, Gabriel Gwanmesia, Anne Pommier, Yanbin Wang.



1. 6000-ton multi-anvil press

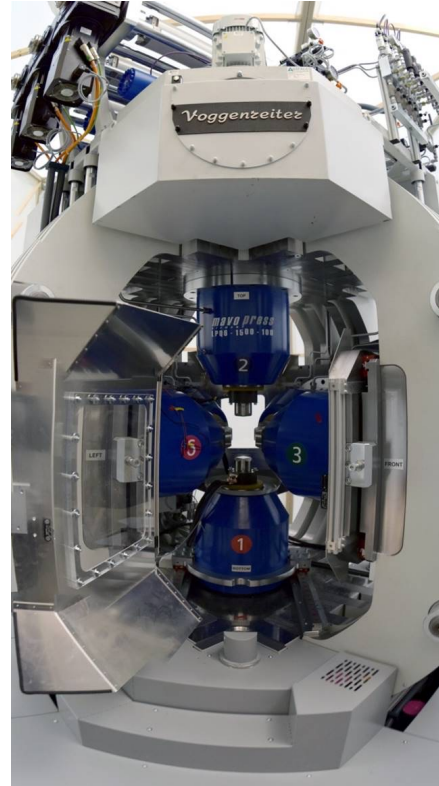

2. 6-axis cubic press



3. Torsional-stress apparatus

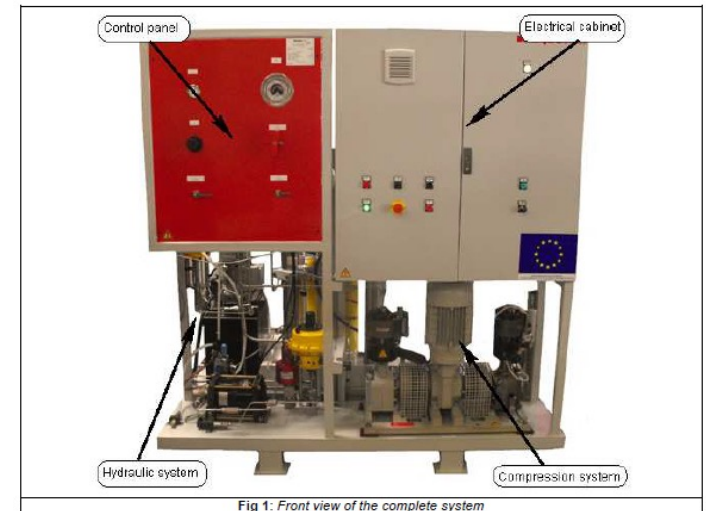

4. 10 kilobar gas vessel

Scientific advantages of FORCE:

- An open facility (hosting equipment new to the US) that will allow users from all over the USA and the world access to large-volume high-pressure samples and conditions relevant to the Earth from the crust to the lowermost Mantle.
- Large samples, single crystals; pressure, and temperature conditions over a wide range.
- Programs for students (graduate and undergraduate), workshops, outreach.

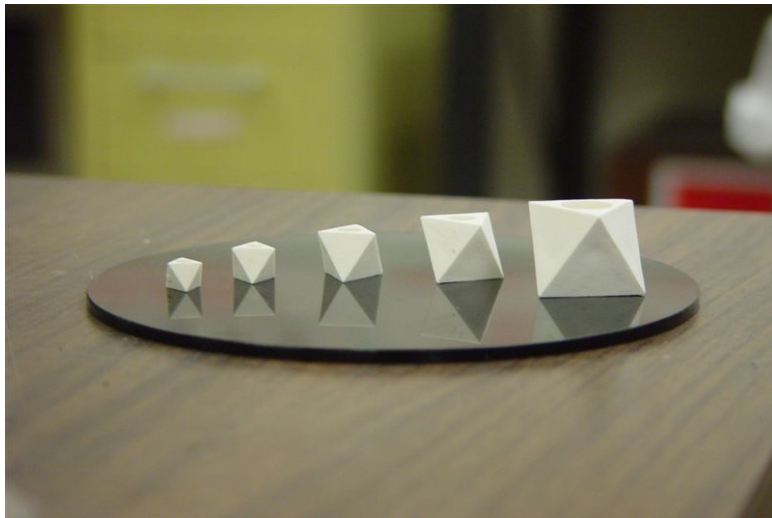

Different sizes of octahedral pressure media for simulating conditions of the Earth's mantle.
Photo courtesy of K. Leinenweber:

8 mm (20-25 GPa)
10 mm (15-20 GPa)
14 mm (9-15 GPa)
18 mm (5-9 GPa)
25 mm (1-5 GPa)

Status of PSF Renovation



PSF 210 labs in process of being commissioned and ready for occupation.

**ROOM COUNT LEGEND
SCHEME D-1:**

FACULTY/RESEARCH
OFFICE
APPROX 150 SQ. FT.
QTY: 17

STAFF OFFICE
APPROX 140 SQ. FT.
QTY: 9 (10 DESKS)

PD OFFICE
(2-3 PERSON)
APPROX 145 SQ. FT.
QTY: 21 DESKS

GA DESKS
QTY: 34

INSTRUMENT LAB
APPROX 964 SQ. FT.

DRY COMP LAB
APPROX 404 SQ. FT.

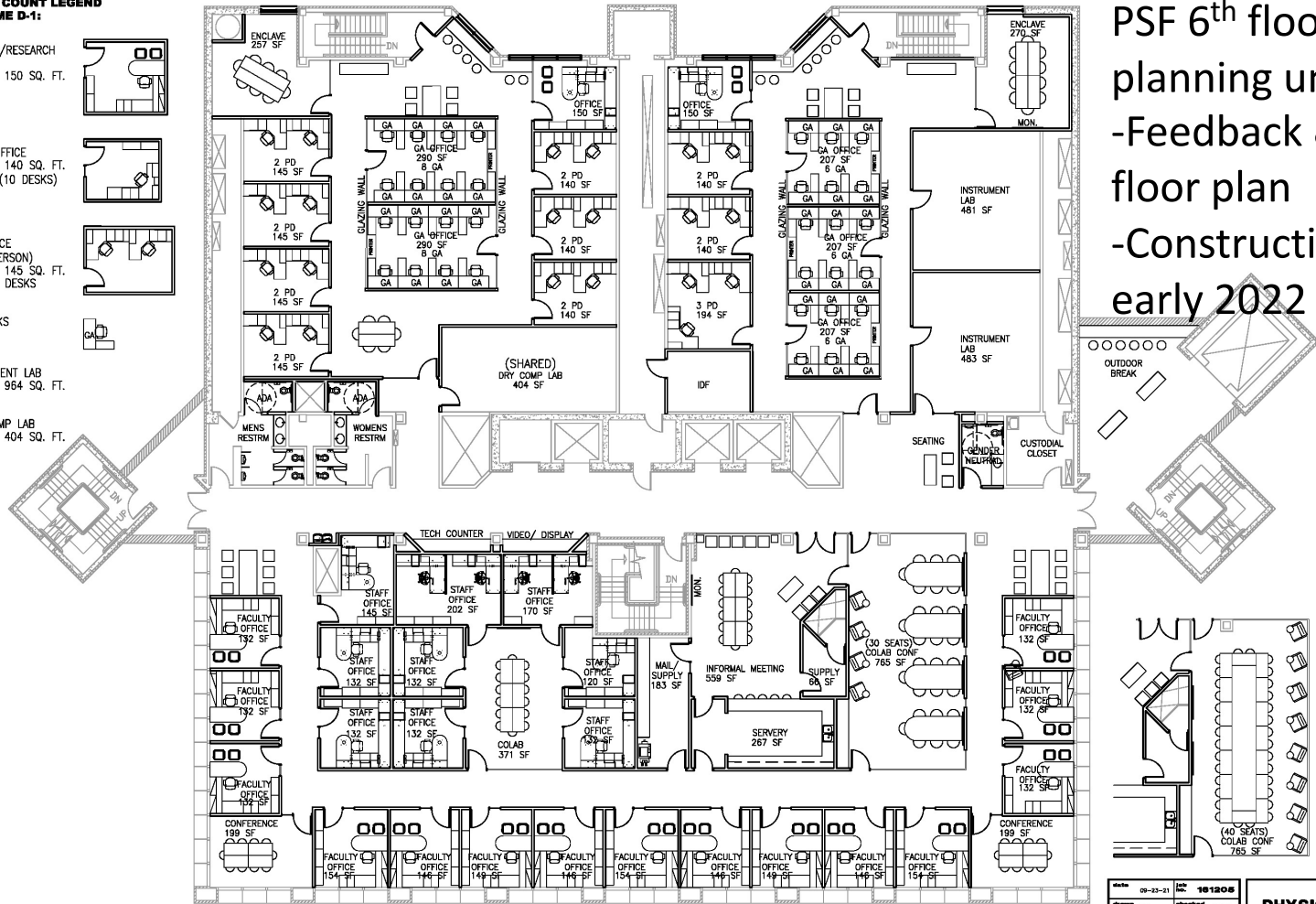

SIXTH FLOOR PLAN

SCHEME D-1

SCALE: 1/16" = 1'-0"



PSF 6th floor renovation
planning underway:
-Feedback & decision on a
floor plan
-Construction beginning in
early 2022

DATE: 08-22-21	REV: 161205
BY: PM	APPROVED: R/A/E
SHEET TITLE	
CONCEPT PLAN	
REVISION	
1. THE DESIGN IS A PRELIMINARY CONCEPT. IT IS NOT A FINAL DESIGN. IT IS NOT TO BE USED FOR CONSTRUCTION. IT IS NOT TO BE USED FOR ANY OTHER PURPOSE. IT IS NOT TO BE USED FOR ANY OTHER PURPOSE. IT IS NOT TO BE USED FOR ANY OTHER PURPOSE.	
PHYSICAL SCIENCES F-WING 6TH FLR CONCEPT LAYOUTS ARIZONA STATE UNIVERSITY TEMPE, AZ	
LEA - Architects, LLC 1730 EAST NORTHERN PHOENIX, AZ ARCHITECTURE PLANNING INTERIOR CONSTRUCTION MEAT.	



Negotiating moves within ISTB4 to account for new hire needs and possible new virtual learning environment

SESE Virtual Classroom

- Susie Marston gifted \$700K earlier this year to SESE for establishing a Virtual Classroom (the first on ASU's campus)
- Will likely be situated on the 2nd floor of ISTB4
- Virtual Classroom Working Group:
 - Kip Hodges, chair
 - Ramon Arrowsmith (ex officio)
 - Ariel Anbar
 - Karen Knierman
 - Darryl Reano
 - Chris Skiba
 - Molly Simon

Upgrade of ISTB4 Exhibit Gallery

President Crow has allocated \$200K earlier for upgrading the ISTB4 gallery, including:

- Full scale model of the Psyche spacecraft
- Upgrade of Magic Planet projectors



Fall 2021 Community-wide Activities

Activities open to all SESE personnel during Fall 2021 (virtual unless noted otherwise):

- SESE Community Conversations (Noon-1 PM on Sept 30, Oct 28, and Dec 2) – hybrid (Marston Theater)
- Open monthly listening sessions with AD ICs & other SESE leadership (first Wednesday of Sept, Oct, Nov, and Dec, 10:20-11:30 AM)
- SESE Colloquium (Wed, 3:30-4:30 PM, weekly) – hybrid event (Marston Theater)
- Virtual Tea (Thurs, 2:00-2:30 PM, weekly)
- Engineering Coffee (Fri, 2:30-3:30 PM, weekly, beginning Sept 10) - hybrid (ISTB4 692)
- Director's open office hours (weekly, 9-11 AM Fri) – (in-person, if requested)